

# USC LANCASTER

## Roof Repair - Carol Ray Dowling Health Services Building

### LANCASTER, SOUTH CAROLINA

#### STATE PROJECT NO. H37-1315



Architects:  
**Michael Keeshen & Associates, Inc.**  
 Architecture and Interior Design  
 101 E. Washington St.  
 Suite 200  
 Greenville, South Carolina 29601  
 Phone 864-233-2804  
 Fax 864-233-6567

Consultants:

A	ABADONED
ANSI	AMERICAN NATIONAL STANDARDS INSTITUTE
DS	DOWNSPOUT
ETC	ET CETERA
MAX	MAXIMUM
MIN	MINIMUM
N.I.C.	NOT IN CONTRACT
NRCA	NATIONAL ROOFING CONTRACTORS ASSOCIATION
O.C.	ON CENTER
OP	OVERHEAD POWER
OSHA	OCCUPATIONAL SAFETY AND HEALTH ASSOCIATION
SB	SPLASH B LOCK
SMACNA	SHEET METAL AND AIR CONDITIONING CONTRACTORS ASSOCIATION, INC.
SWRI	SEALANT WATERPROOFING AND RESTORATION INSTITUTE
TYP	TYPICAL
VTR	VENT THRU ROOF
W/	WITH

#### 15E ABBREVIATIONS

SCALE: N.T.S.

	REVISION TAG NOTATION		COLUMN LINE DESIGNATION
	BUILDING SECTION NOTATION		ELEVATION NOTATION
	WALL SECTION NOTATION		NORTH ARROW COMPASS POINTS REFER TO ARCHITECTURAL DRAWINGS AND DO NOT REFLECT TRUE SITE ORIENTATION
	PLAN REFERENCE/REFERENCE SHEET		ELEVATION NOTATION
	NOT IN CONTRACT		PLAN REFERENCE NOTATION
	PLAN REFERENCE REFERENCE SHEET		DETAIL REFERENCE NOTATION
	TURBINE EXHAUST		PLAN NOTE NOTATION
	EXHAUST VENT		FIRE RATED WALL DESIGNATION - 1 HR
	VENT THRU ROOF PIPE		FIRE RATED WALL DESIGNATION - 2 HR
	PLAN DEMOLITION NOTES		COLUMN
	PLAN CONSTRUCTION NOTES		DOWNSPUT/GUTTER
			SLOPE
			OVERHEAD POWER

#### 15L SYMBOL LEGEND

SCALE: N.T.S.

A0.01	COVER AND CODE REVIEW
A2.01	ROOF PLAN
A2.11	ROOF DETAILS

#### 15N DRAWING INDEX

SCALE: N.T.S.

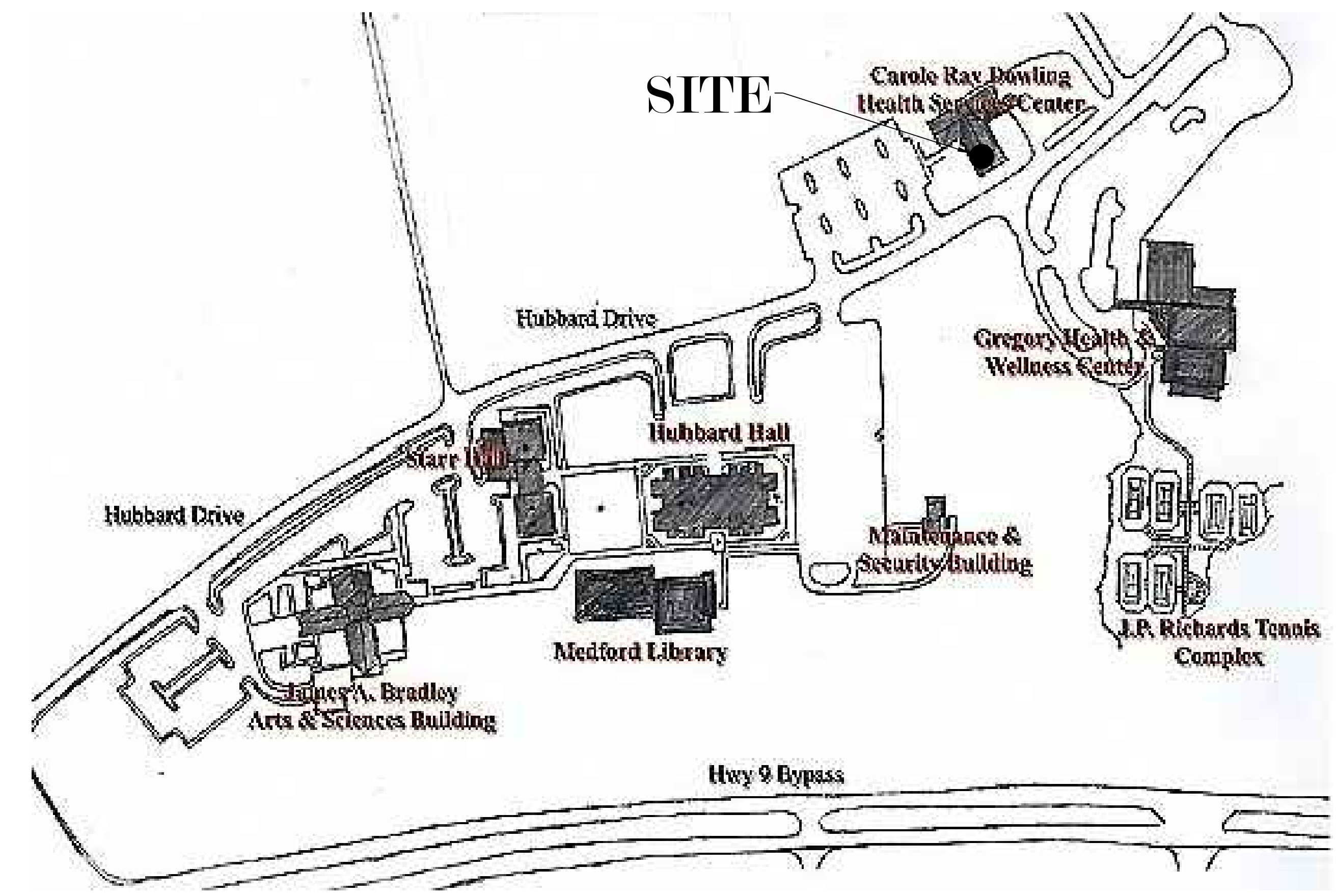

1J VICINITY MAP  
SCALE: N.T.S.

#### GENERAL NOTES

- PRIOR TO PERFORMING WORK, CONTRACTOR SHALL INSPECT SURFACES AND SUBSTRATE CONDITIONS. PROVIDE FOR THE SAFETY AND PROTECTION OF WORKERS AND OCCUPANTS THROUGHOUT THE COURSE OF WORK.
- ALL BUILDING DIMENSIONS, EXISTING CONDITIONS, ITEM LOCATIONS, SIZE AND QUANTITY OF PENETRATIONS SHALL BE FIELD VERIFIED BY THE CONTRACTOR PRIOR TO BID.
- SITE SHALL BE CLEANED ON A DAILY BASIS AND SECURED AT THE END OF EACH WORK DAY.
- BUILDING ACCESS SHALL BE COORDINATED WITH THE OWNER AND SHALL BE ONLY AS REQUIRED TO ACCOMPLISH CONTRACT WORK. FACILITIES MAY BE OCCUPIED DURING CONSTRUCTION. CONTRACTOR SHALL TAKE ALL NECESSARY PRECAUTIONS TO PROTECT THE FACILITY, CONTENTS, AND OCCUPANTS.
- THE BUILDING SHALL BE WEATHERTIGHT AT THE END OF EACH DAYS WORK AND WHEN INCLEMENT WEATHER THREATENS.
- CONTRACTOR SHALL PROTECT THE SITE AND GROUNDS INCLUDING SURFACES, GRASS, PLANTS, TREES SHRUBS AND OTHER LANDSCAPING. THE CONTRACTOR SHALL REPLACE ANY DAMAGED ITEMS.
- THE CONTRACTOR SHALL REPLACE ANY BUILDING SURFACES THAT ARE STAINED, MARRED, OR DAMAGED DURING CONSTRUCTION.

10N GENERAL NOTES  
SCALE: N.T.S.

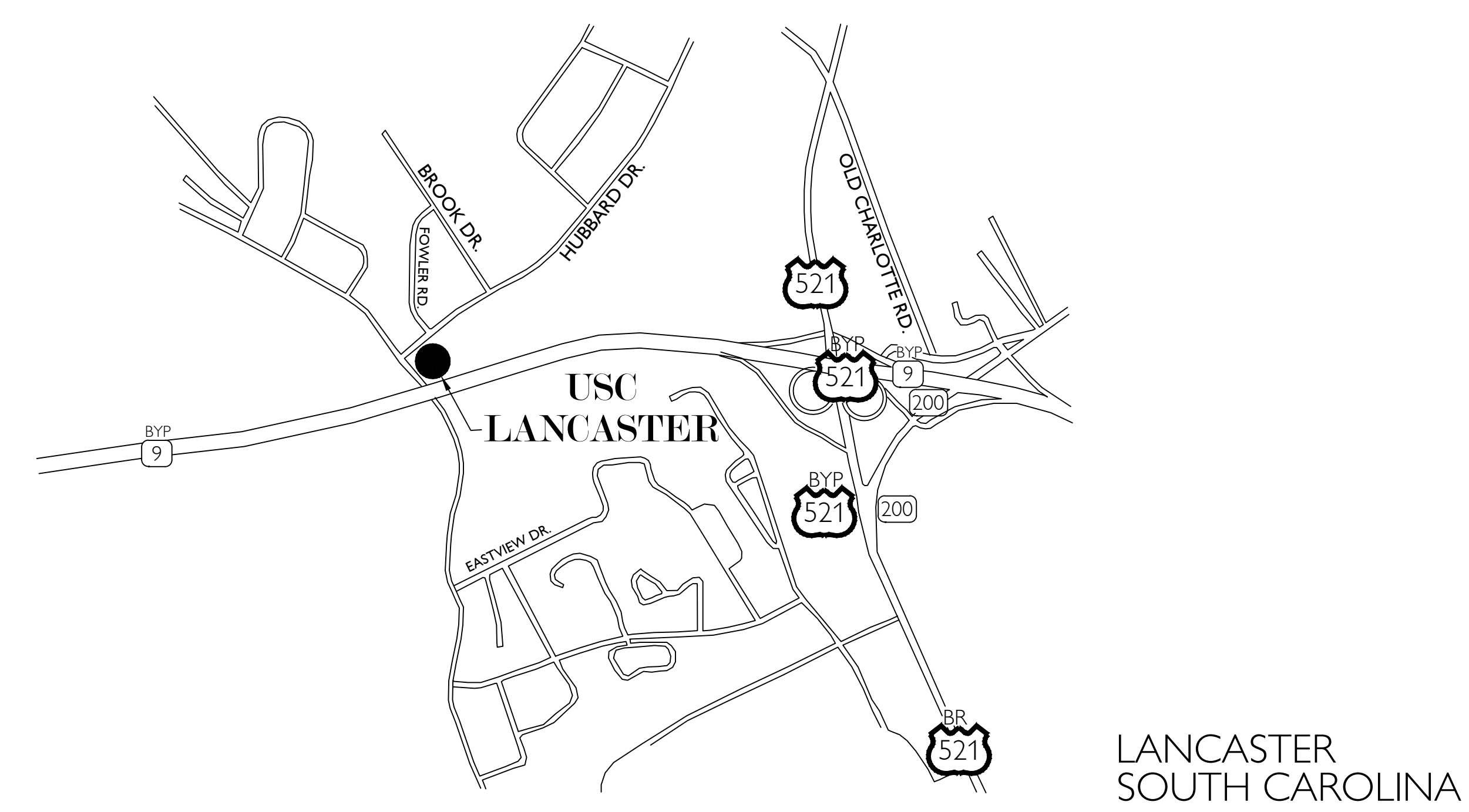

1N LOCATION  
SCALE: N.T.S.

Project Title:  
**USC LANCASTER ROOF REPAIR CAROL RAY DOWLING HEALTH SVC BLDG.**



Seals:

Revisions:  
 #####

Project Number: 11032  
 Phase: CD SUBMITTAL  
 Date: 11.10.2011  
 Drawn By: DK1  
 Checked By: MEK  
 Sheet Number:

**A0.01**  
 COVER AND CODE REVIEW

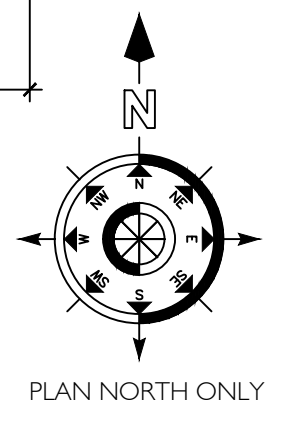
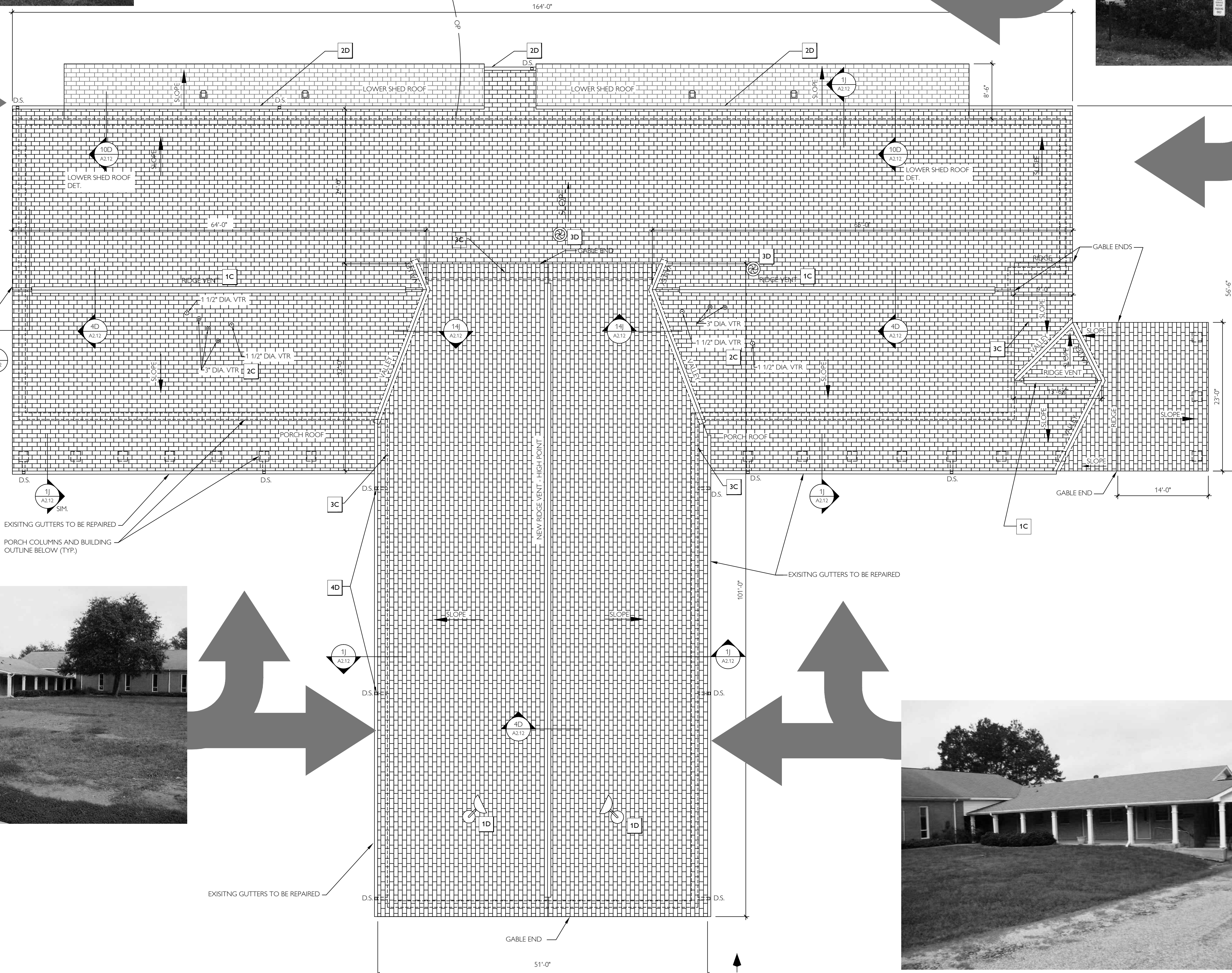

1N ROOF PLAN  
SCALE: 1/8" = 1'-0"

16D DEMOLITION GEN. NOTES  
SCALE: N.T.S.

- 1D REMOVE EXISTING LIGHT FIXTURES AND PATCH OPENING.
- 2D REMOVE GUTTER AND DOWNSPOUTS. REMOVE DETERIORATED FASCIA ENTIRE LENGTH OF THIS EDGE. SEE DETAIL 19A2-12 FASCIA BOARD.
- 3D REMOVE AND REPLACE TURBINE EXHAUST FAN. MATCH EXISTING.
- 4D REMOVE AND REPLACE DETERIORATED FASCIA WITH CEMENT BOARD. RE-ATTACH EXISTING GUTTER IN THIS AREA DESIGNATED.

16G DEMOLITION PLAN NOTES  
SCALE: N.T.S.

1. SUBSTRATE SHALL BE INSPECTED AND REPAIRED PRIOR TO NEW SHINGLE ROOF SYSTEM INSTALLATION. EXISTING DAMAGED OR DETERIORATED CARPENTRY NOT OTHERWISE INDICATED FOR REPLACEMENT SHALL BE REMOVED AND REPLACED IN ACCORDANCE WITH UNIT PRICES.
2. ROOFING AND SHEET METAL SHALL BE IN STRICT ACCORDANCE WITH CONTRACT REQUIREMENTS. ANY CLARIFICATIONS OR ADDITIONAL INFORMATION SHALL BE IN ACCORDANCE WITH PUBLISHED GUIDELINES OF NCA ROOFING AND WATERPROOFING MANUAL (5TH EDITION) AND SMACNA ARCHITECTURAL SHEET METAL MANUAL (6TH EDITION).
3. ALL FLASHING TERMINATIONS SHALL HAVE WATERTIGHT SHEET METAL CLOSURES, AND WATERPROOF UNDERLAYMENT. ALL SHEET METAL SHALL HAVE SEALED LAP JOINTS.
4. SPECIFIC AND TYPICAL DETAILS ARE PROVIDED W/ GENERIC TYPE DECK SHOWN. TYPICAL DETAILS APPLY TO ALL INSTANCES WHERE SIMILAR CONDITIONS OCCUR.

16K NEW WORK GEN. NOTES  
SCALE: N.T.S.

- 1C REUSE EXISTING RIDGE VENT
- 2C SEE DETAIL 19A2-12 FOR ALL VTR (VENT THROUGH ROOF) PIPE PENETRATIONS
- 3C CONTRACTOR TO REPLACE EXISTING STEP FLASHING AND MAKE WATER TIGHT THE JUNCTION BETWEEN THE ROOF AND WALL.

16N NEW WORK PLAN NOTES  
SCALE: N.T.S.



Architects:  
**Michael Keeshen & Associates, Inc.**  
Architecture and Interior Design  
101 E. Washington St.  
Suite 200  
Greenville, South Carolina 29601  
Phone 864.233.2804  
Fax 864.233.6567

Consultants:

Project Title:  
**USC LANCASTER  
ROOF REPAIR  
CAROL RAY DOWLING  
HEALTH SVC BLDG.**



Seals:

Revisions:  
#####

Project Number:  
11032  
Phase:  
CD SUBMITTAL  
Date:  
11.10.2011  
Drawn By:  
DKI  
Checked By:  
MEK  
Sheet Number:

**A2.11**  
Sheet Title:  
ROOF PLAN

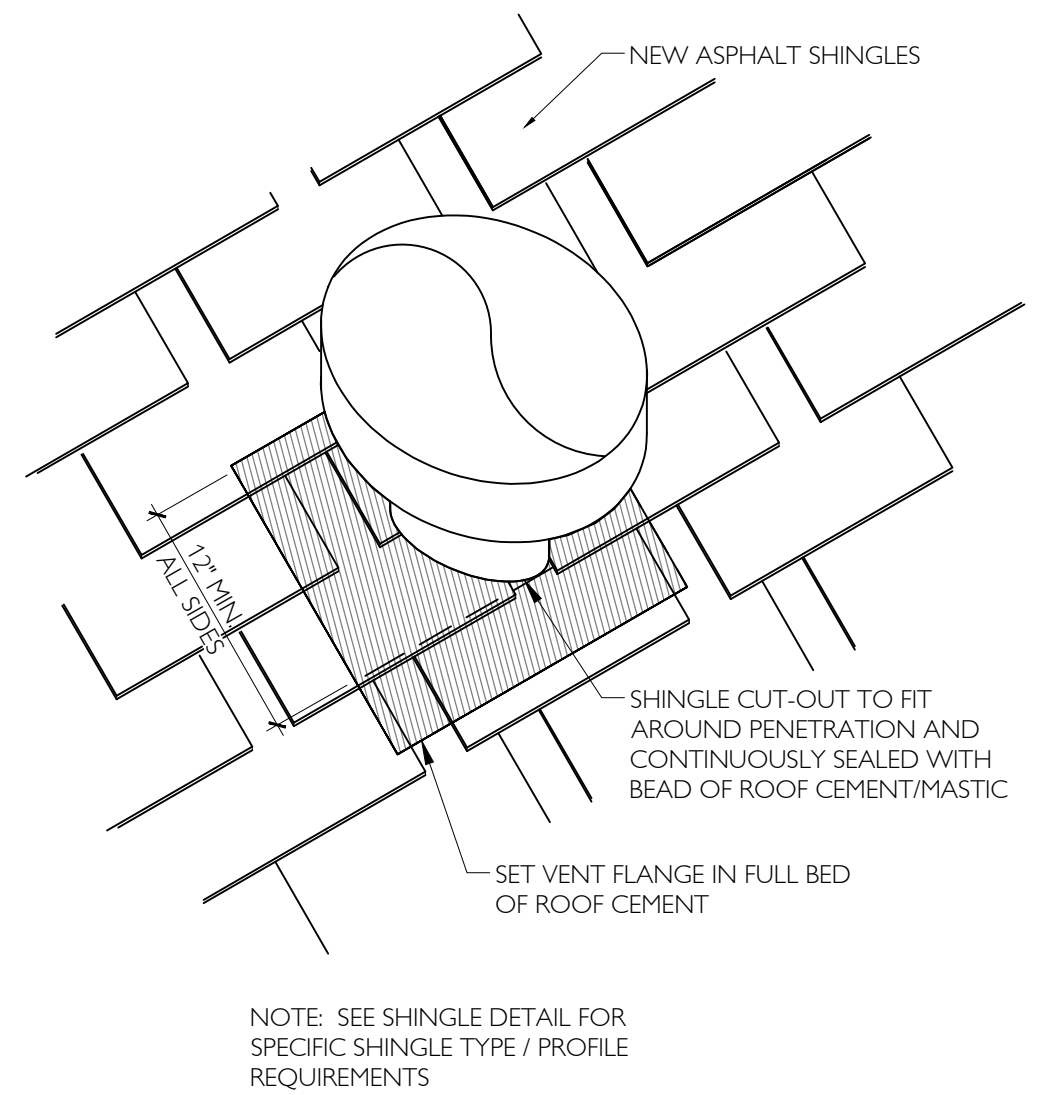

1D TURBINE EXHAUST DETAIL  
SCALE: N.T.S.

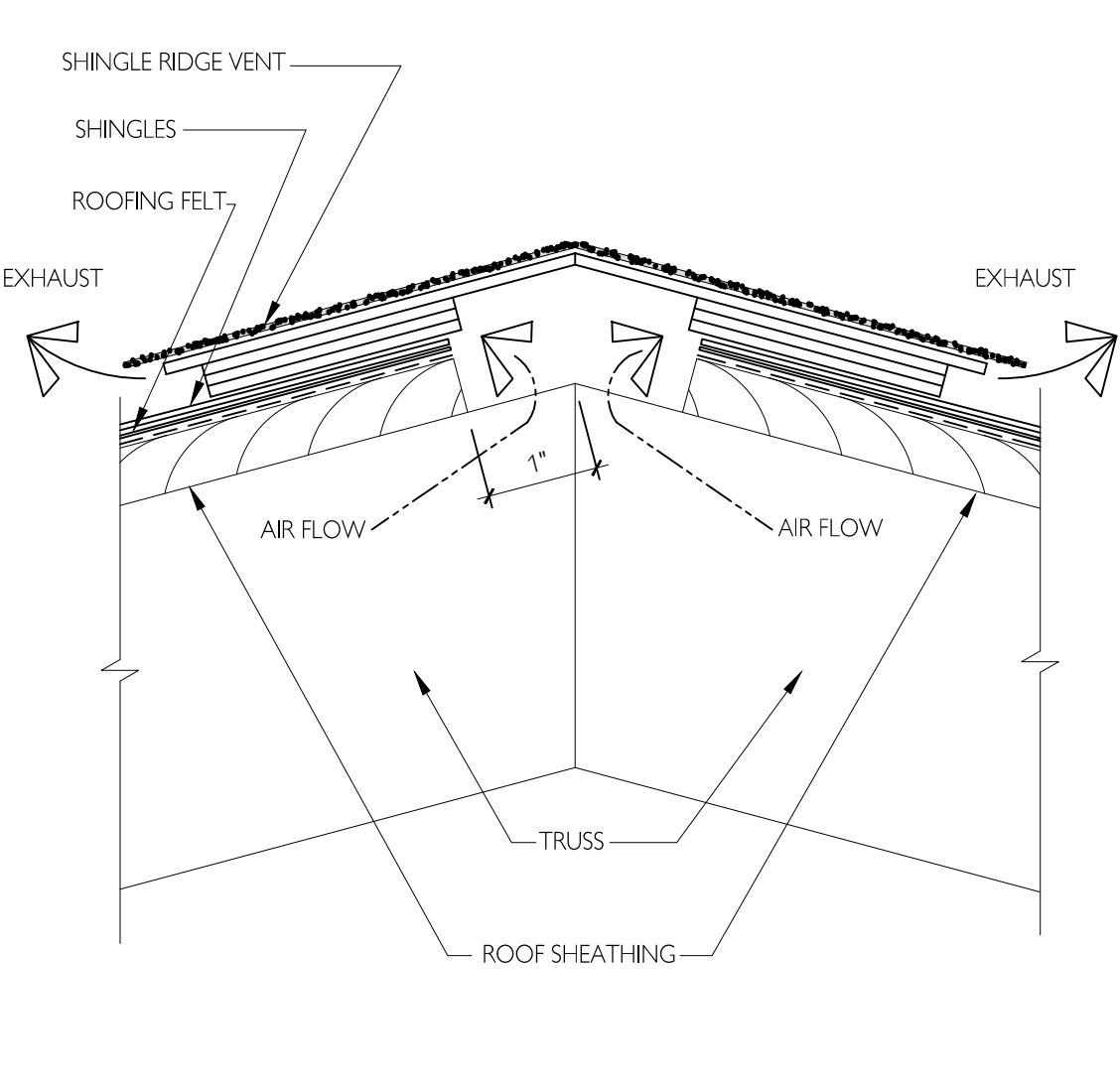

4D RIDGE VENT DETAIL  
SCALE: N.T.S.

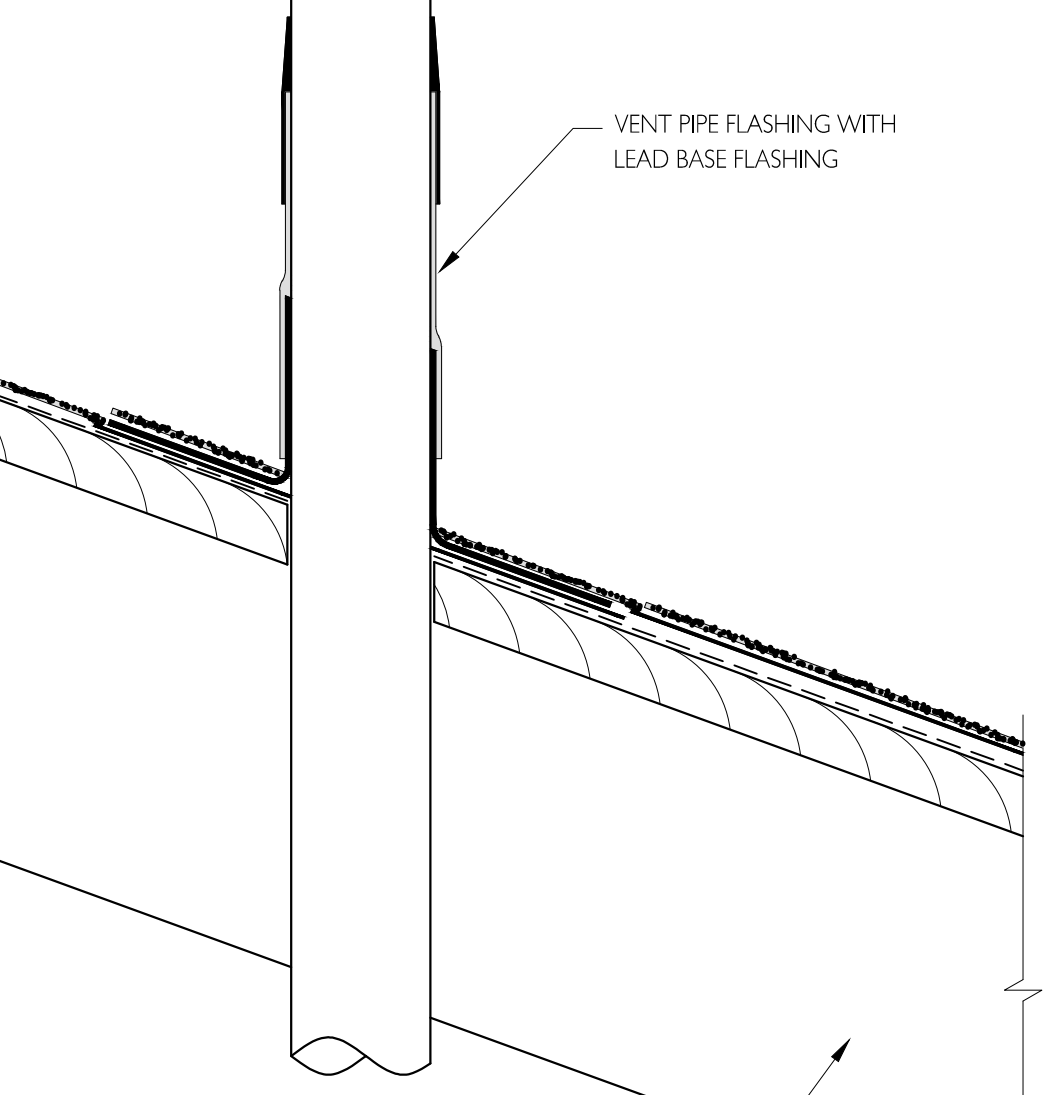

7D PIPE PENETRATION DETAIL  
SCALE: N.T.S.

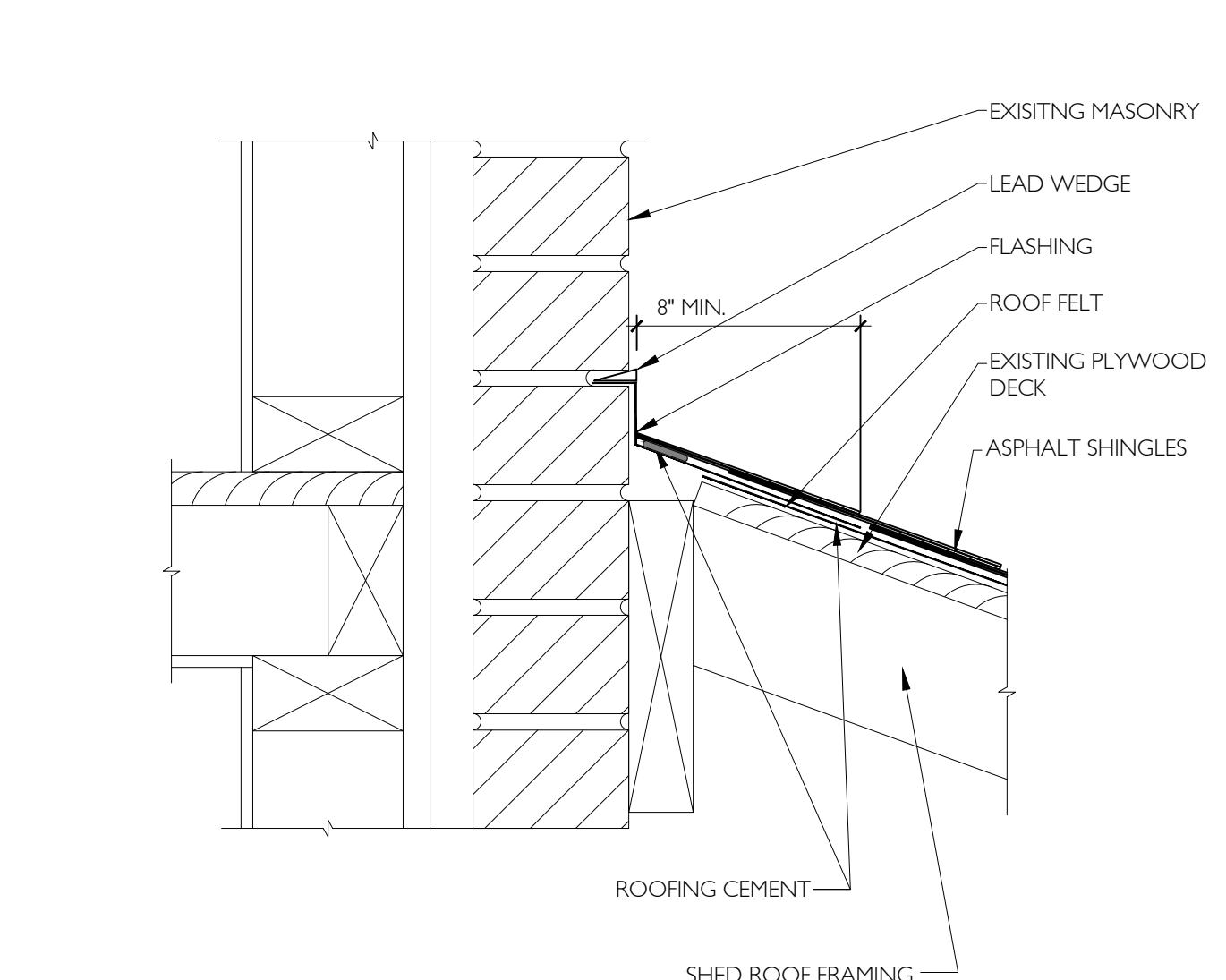

10D SHED ROOF FLASHING DETAIL  
SCALE: 3/4" = 1'-0"

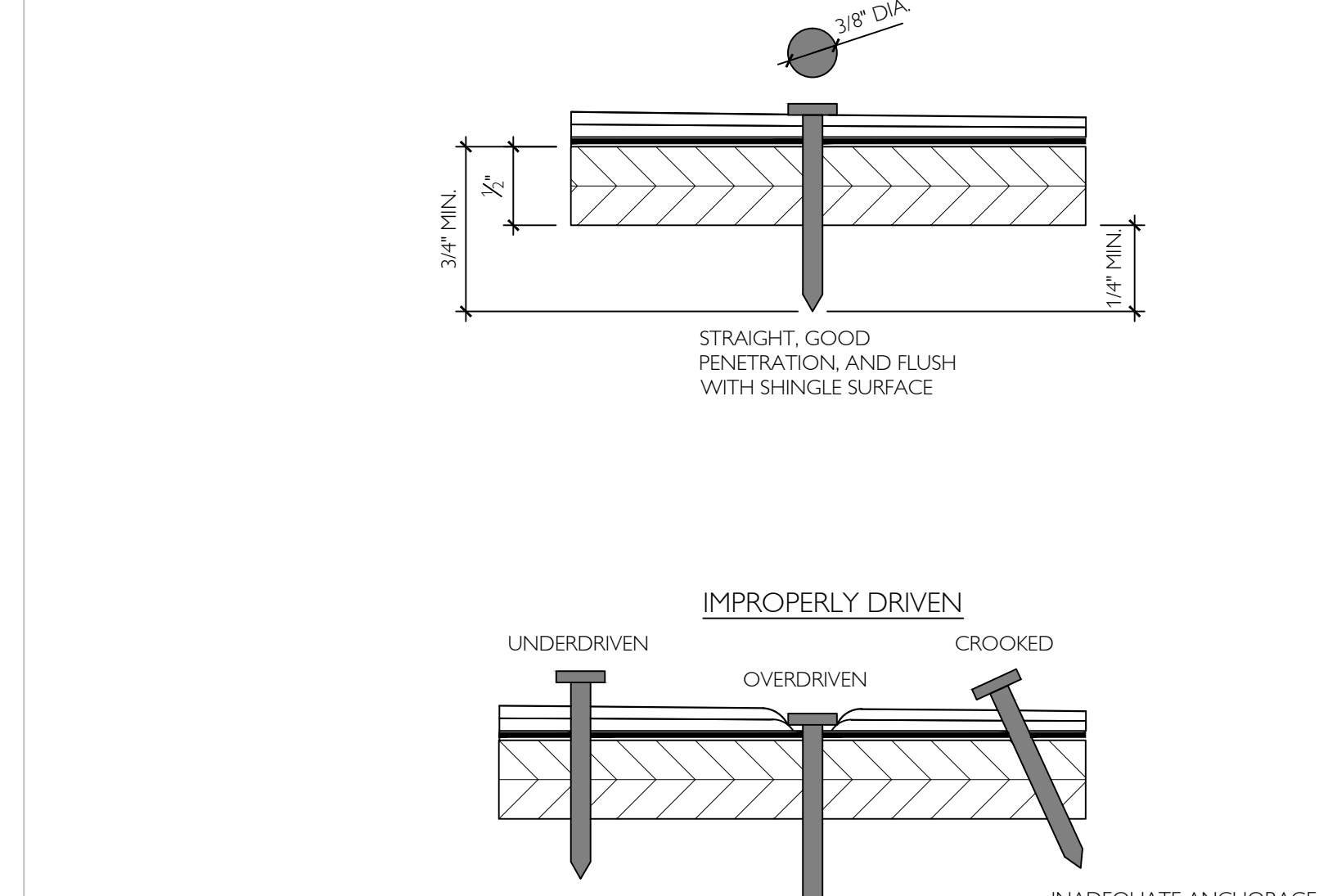

14D APPLICATION OF ROOFING NAILS  
SCALE: N.T.S.

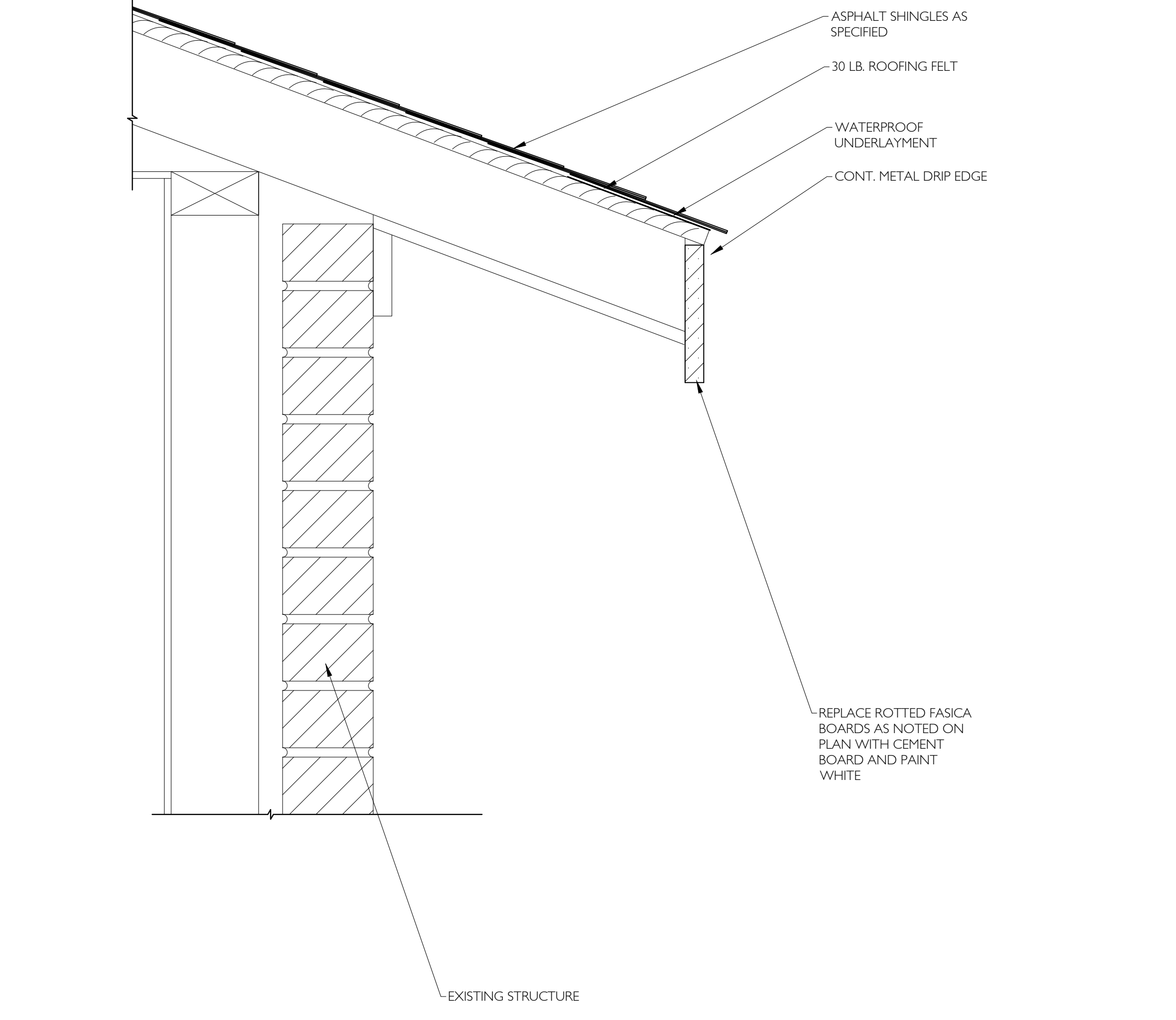

1J FASCIA DETAIL  
SCALE: 3/4" = 1'-0"

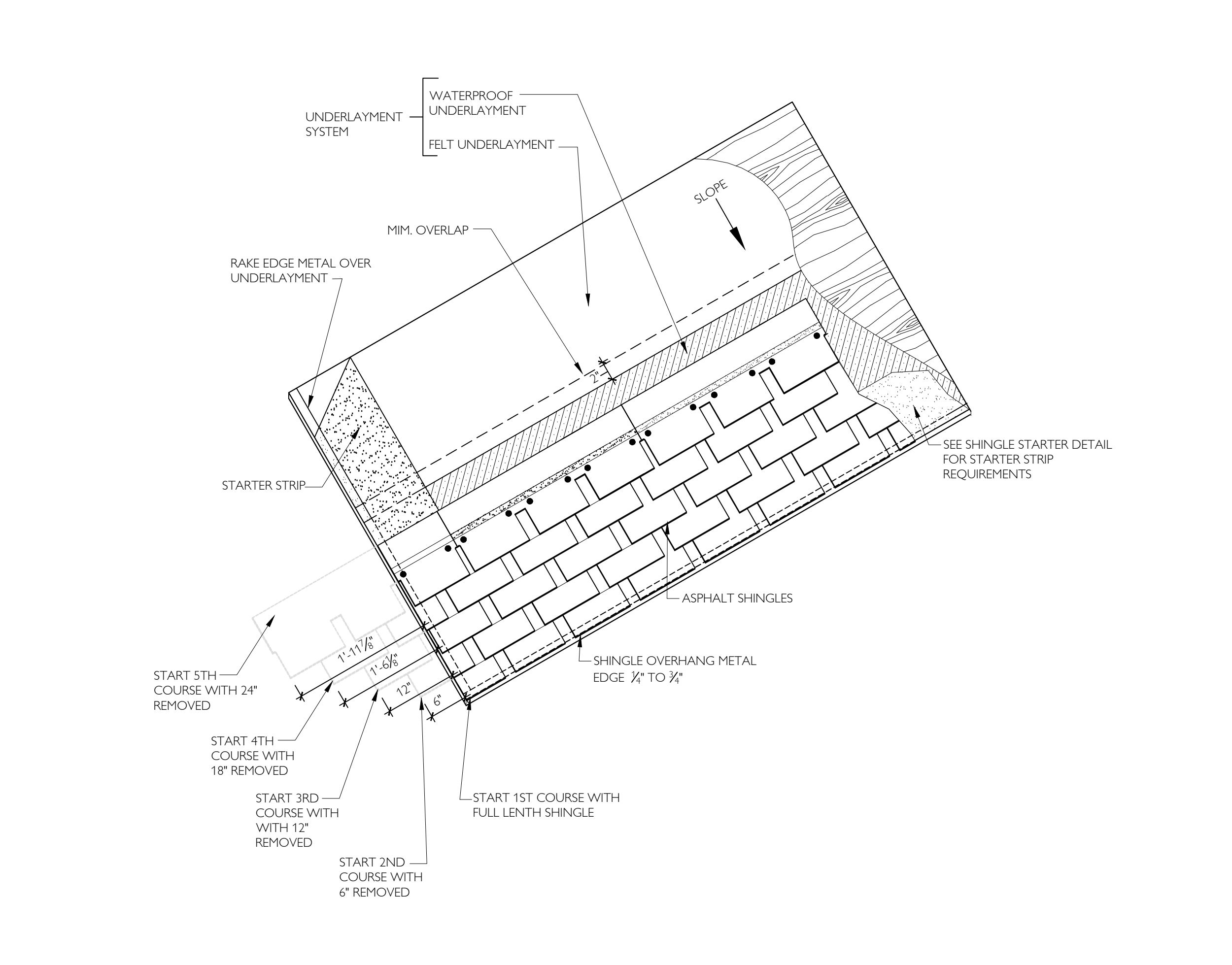

7L LAMINATED SHINGLE APPLICATION DETAIL  
SCALE: N.T.S.

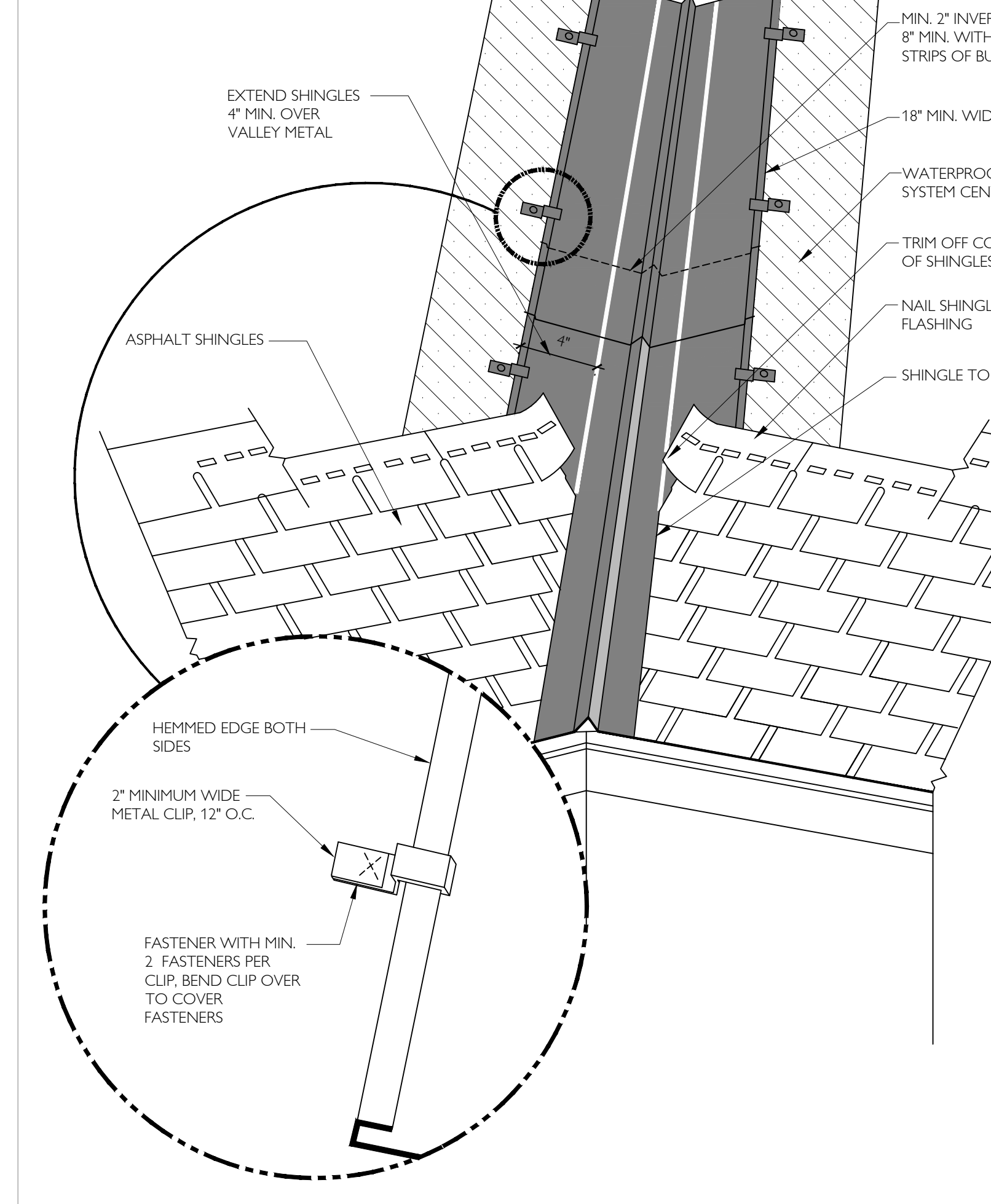

14J OPEN METAL VALLEY DETAIL  
SCALE: N.T.S.

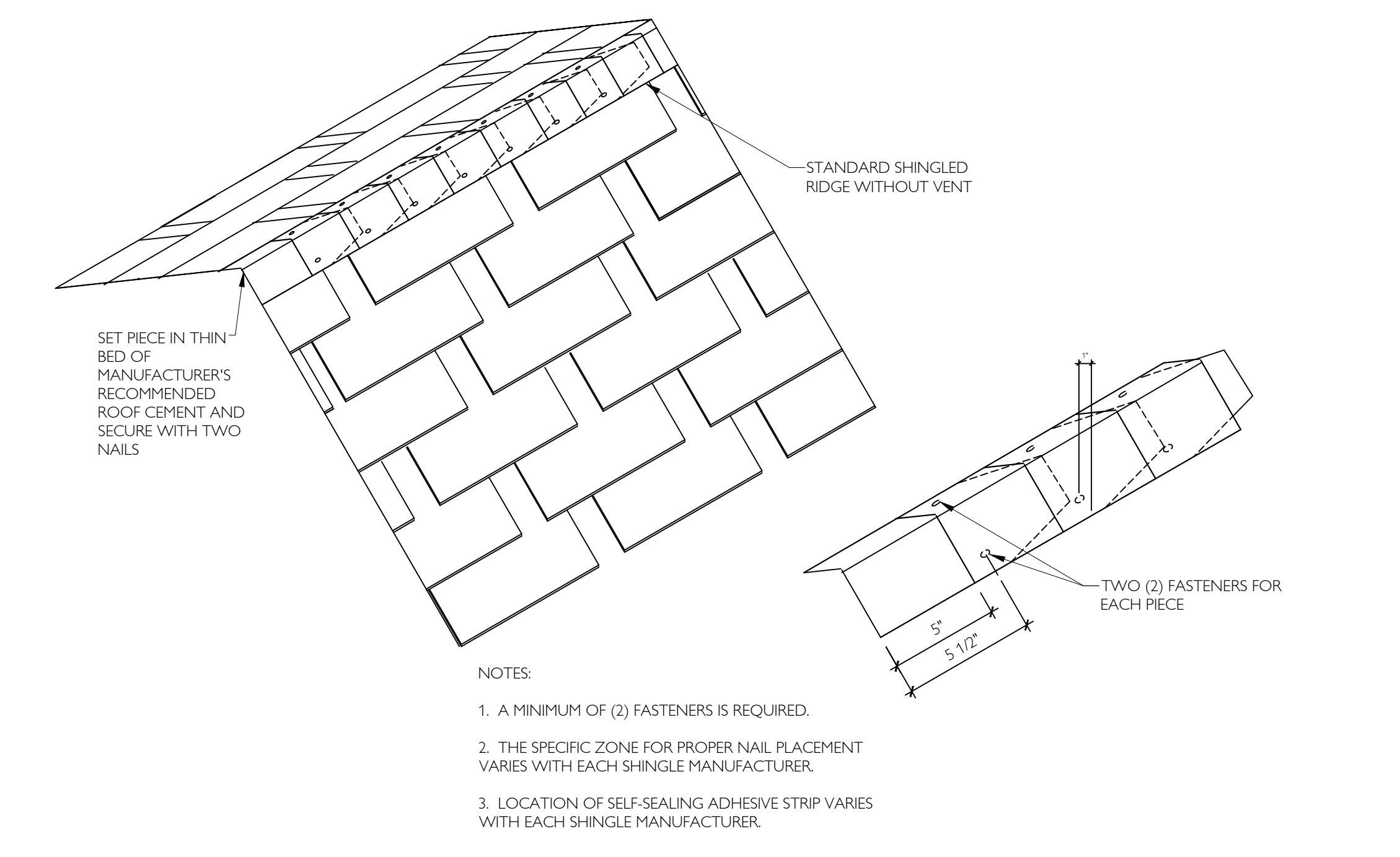

1N RIDGE SHINGLE DETAIL  
SCALE: N.T.S.

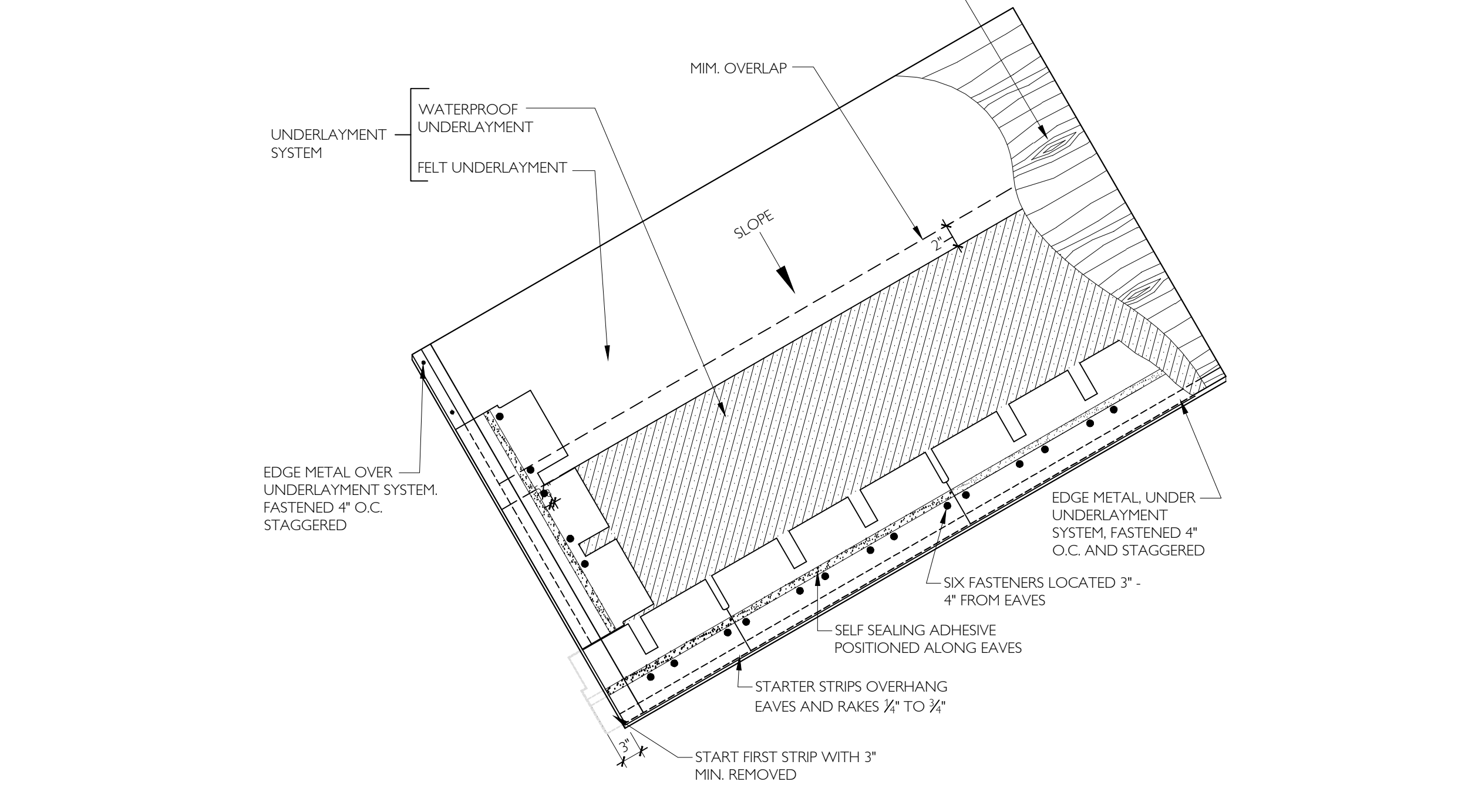

7N SHINGLE STARTER STRIP DETAIL  
SCALE: N.T.S.

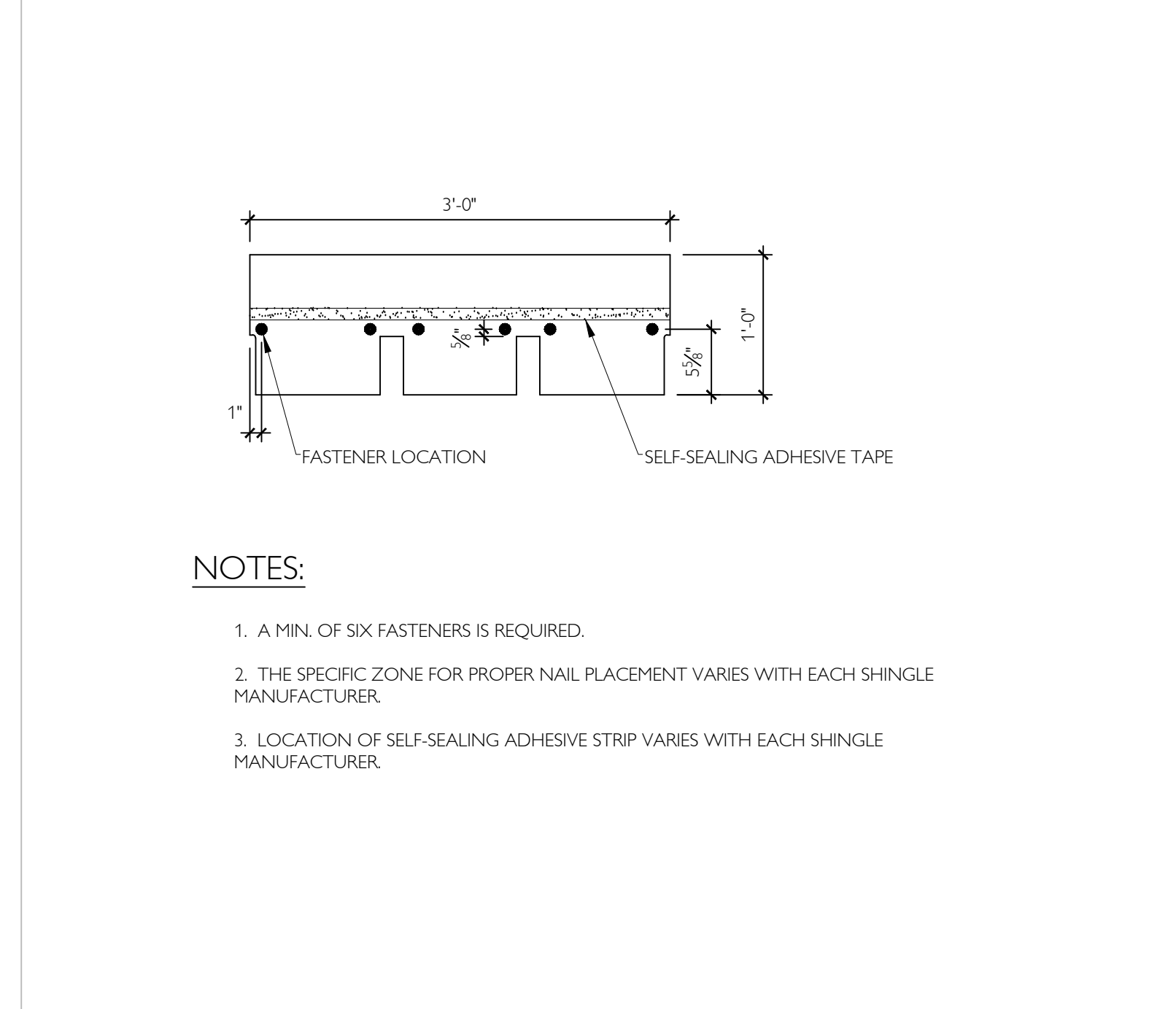

14N ARCHITECTURAL SHINGLE DETAIL  
SCALE: 1 1/2" = 1'-0"



Architects:  
Michael Keeshen & Associates, Inc.  
Architecture and Interior Design  
101 E. Washington St.  
Suite 200  
Greenville, South Carolina 29601  
Phone 864.233.2804  
Fax 864.233.6567

Consultants:

Project Title:  
**USC LANCASTER  
ROOF REPAIR  
CAROL RAY DOWLING  
HEALTH SVC BLDG.**



Seals:

Revisions:  
#####

Project Number:  
11032  
Phase:  
CD SUBMITTAL  
Date:  
11.10.2011  
Drawn By:  
DKI  
Checked By:  
MEK  
Sheet Number:

**A2.12**  
Sheet Title:  
ROOF DETAILS